

VIEW	TOLERANCE	
	0-10	±1
	11-250	±5
UNIT: mm	251-500	±10
	501-1000	±20
	1001-3000	±50
	3001-5000	±100
	5001- >	±150

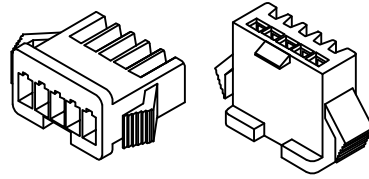

Δ Order Code : **WW250-XX-F**

**Female**  
**Number of contact : 2 to 12 pin**

**TTAF  
 APPROVAL**

Δ Material : Nylon 66 UL94V-0

Voltage Rating : 250V AC,DC  
 Current Rating : 2.5A.  
 Withstanding Voltage : 800V AC/minute  
 Insulation Resistance : 1.000M Ω Min  
 Temperature Range : -25 °C ~ + 85 °C

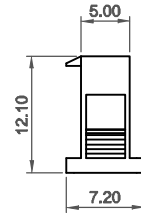
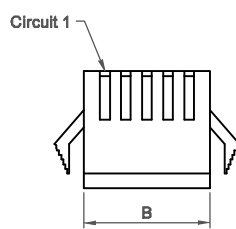
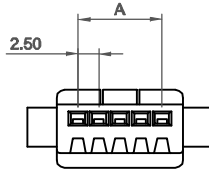

Contact No.	Dimensions(mm)	
	A	B
2	2.50	5.50
3	5.00	8.00
4	7.50	10.50
5	10.00	13.00
6	12.50	15.50
7	15.00	18.00
8	17.50	20.50
9	20.00	23.00
10	22.50	25.50
11	25.00	28.00
12	27.50	30.50

Date	14.05.2015	Rev.	-	Revision Detail		Rev.Dt.		Rev.by		Part No	<b>WW250-XX-F</b>	
Designed by	Yeşim AKSOY									Drawing Nr.		-
Checked by	Fatih BOLACA									Scale		NONE
										Sheet No	1/1	