

| VIEW     | TOLERANCE |       |
|----------|-----------|-------|
|          | 0-5       | ±0.1  |
|          | 6-10      | ±0.25 |
|          | 11-50     | ±0.5  |
| UNIT: mm | 51-100    | ±1    |
|          | 101-250   | ±2    |
|          | 251-500   | ±5    |
|          | 501- >    | ±10   |

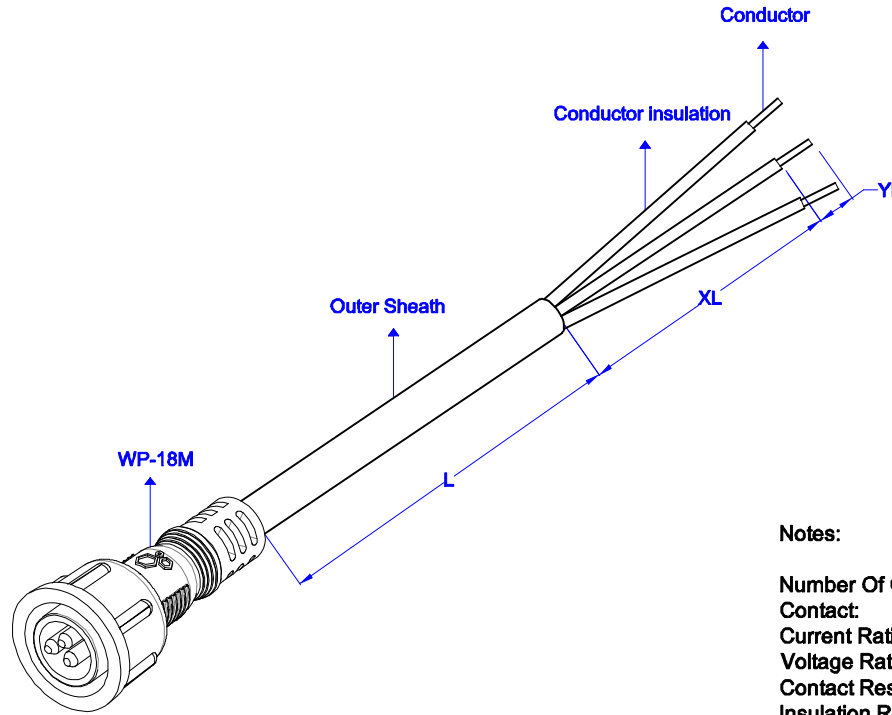

**Notes:**

Number Of Contact: 3 Pin  
 Contact: Brass Nickel Plated  
 Current Rating Percontact: 2,5A  
 Voltage Rating: 220V AC  
 Contact Resistance: <10M Ω  
 Insulation Resistance: 1000M Ω at DC 500V.  
 Breakdown Voltage: 1,5KV / 1 minute  
 Temperature Rating: -30C°~+70C°  
 Durability (Plug/Unplug): 3000 times  
 Waterproof Rating: IP67  
 Certificate: CE ; ROHS

**ORDER CODE:**

WP-18M XXXX XX X XXX XX X  
 → Conductor Solder : if yes: Y if not: 0  
 → Conductor insulation Stripping : if yes: YL (mm) if not: 00  
 → Outer Sheath Stripping : if yes: XL (mm) if not: 00  
 → Color : B: Black W : White  
 → Cable : BB: PVC H05VV-F (TTR) 3x0,50mm<sup>2</sup> O.D: 6,0 ±0.2  
 → Length : L (mm)

| No | Material Code | Description   | Size (mm) | Q'ty | Unit |
|----|---------------|---|-----------|------|------|
| 6  | -             | PVC MOLDING (black or white)                                      | -         | -    | -    |
| 5  | -             | PVC NUT (black or white)  | -         | -    | pc.  |
| 4  | -             | GASKET (red)  | -         | -    | pc.  |
| 3  | -             | TERMINAL - FEMALE   | -         | -    | pcs. |
| 2  | -             | TERMINAL - MALE   | -         | -    | pcs. |
| 1  | -             | IEC 62(RVV) 300/300V 3x0.75mm <sup>2</sup> CABLE (black or white) | -         | -    | pcs. |

| Date        | 16.12.2016  | Rev.       | -            | Revision Detail |  | Rev.Dt. |  | Rev.by |  | Part No     | WP-18M<br>3 Pin Seal Harness |          |  |
|-------------|-------------|------------|--------------|-----------------|--|---------|--|--------|--|-------------|------------------------------|----------|--|
| Designed by | Yegim AKSOY | Checked by | Fatih BOLACA |                 |  |         |  |        |  | Drawing Nr. | Scale                        | Sheet No |  |
|             |             |            |              |                 |  |         |  |        |  | -           | NONE                         | 1/2      |  |



1

2

3

4

5

6

A4

" Dimensions (mm) "

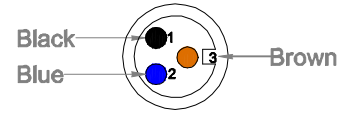
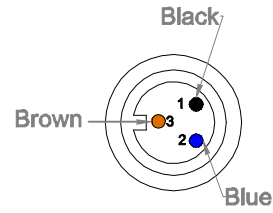

WP-18M

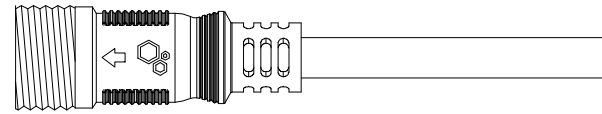
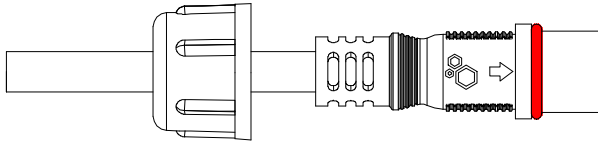

WP-18F

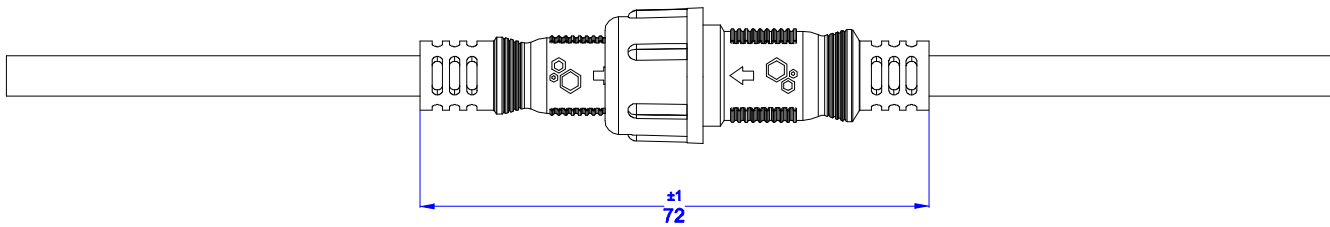
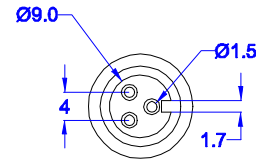
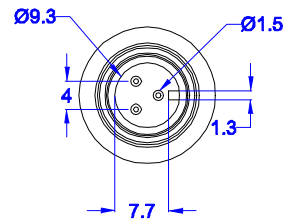

|             |              |      |  |                 |         |        |                                       |       |          |
|-------------|--------------|------|--|-----------------|---------|--------|---------------------------------------|-------|----------|
| Date        | 16.12.2016   | Rev. |  | Revision Detail | Rev.Dt. | Rev.by | Part No                               |       |          |
| Designed by | Yegim AKSOY  | -    |  |                 |         |        | WP-18F / WP-18M<br>Connection Details |       |          |
| Checked by  | Fatih BOLACA |      |  |                 |         |        | Drawing Nr.                           | Scale | Sheet No |
|             |              |      |  |                 |         |        | -                                     | NONE  | 2/2      |



1

2

3

4

5

6

A4