

VIEW	TOLERANCE	
	0-10	±1
	11-250	±5
	251-500	±10
	501-1000	±20
	1001-3000	±50
	3001-5000	±100
	5001+ ->	±150

UNIT: mm

△ Order Code : 9500-XX-S

Straight wafer

Number of contact : 2 to 15 pin

**TTAF
APPROVAL**

△ Material : Nylon 66 UL 94V-0
Pin Material : Brass/Tin Plated

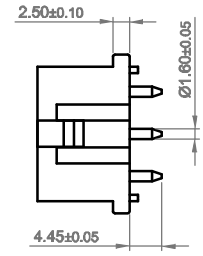
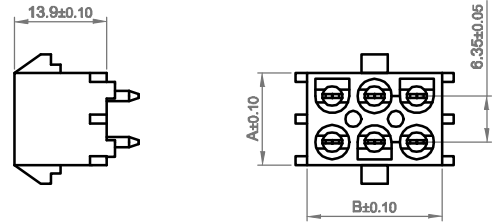
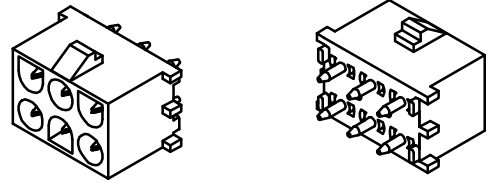

Contact No.	Dimensions(mm)	
	A	B
2	2.00	6.00
3	4.00	8.00
4	6.00	10.00
5	8.00	12.00
6	10.00	14.00
7	12.00	16.00
8	14.00	18.00
9	16.00	20.00
10	18.00	22.00
11	20.00	24.00
12	22.00	26.00
13	24.00	28.00
14	26.00	30.00
15	28.00	32.00

Date	03.11.2014	Rev.	-	Revision Detail		Rev.Dt.		Rev.by		Part No		
Designed by	Yeşim AKSOY									9500-XX-S		
Checked by	Fatih BOLACA											
										Drawing Nr.	Scale	Sheet No
										-	NONE	1/1

