

VIEW	TOLERANCE	
	0-10	±1
	11-250	±5
UNIT: mm	251-500	±10
	501-1000	±20
	1001-3000	±50
	3001-5000	±100
	5001->	±150

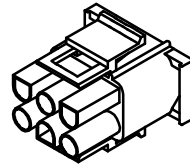
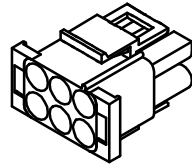

Δ Order Code : 9500-XX-M

Male

Number of contact : 2 to 15 pin

**TTAF
APPROVAL**

Δ Material : Nylon 66 UL 94V-0

Voltage Rating : 600V AC,DC
 Current Rating : 7A
 Withstanding Voltage : 5.000V AC/minute
 Insulation Resistance : 1.000M Ω Min
 Temperature Range : -55 °C ~ + 105 °C

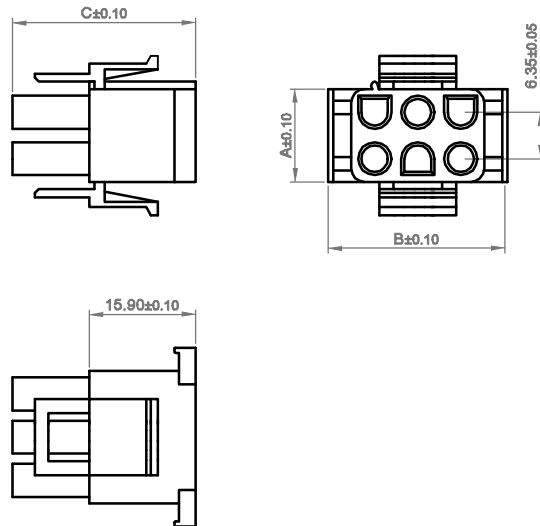

Contact No.	Dimensions(mm)		
	A	B	C
2x1	14.25	14.80	27.70
3x1	20.30	14.70	27.80
4x1	26.67	14.70	27.80
5x1	33.20	14.80	27.80
2x3	13.97	27.70	27.80
3x3	20.50	27.70	28.00
4x3	27.10	27.70	28.00
5x3	33.60	27.90	28.00

Date	03.11.2014	Rev.	Revision Detail	Rev.Dt.	Rev.by	Part No		
Designed by	Yeşim AKSOY	-				9500-XX-M		
Checked by	Fatih BOLACA							
						Drawing Nr.	Scale	Sheet No
						-	NONE	1/1