

4

3

2

1

SCALE

2:1

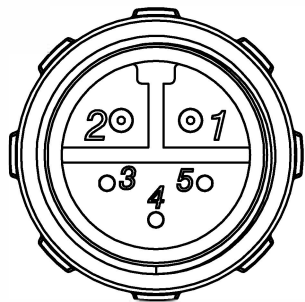

Male needle

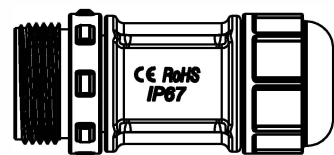
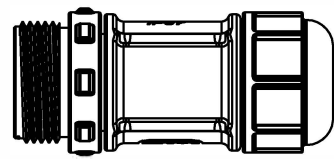
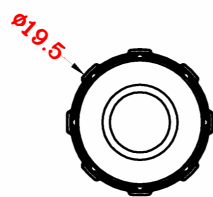
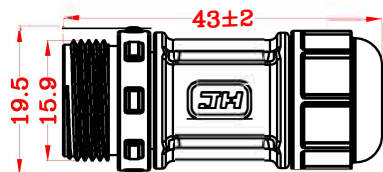
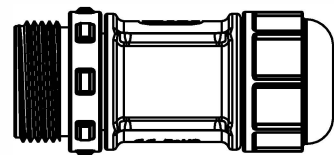

NOTES

1. Rated voltage: 80V AC/DC
2. Rated current: 3A
3. Insulation voltage: 1KV/DC 2mA 1min
4. Insulation resistance: 20MΩ 500V
5. Operating temperature: -40 to 105 °C
6. Protection degree (IP-Code) : IP67
- 7: RoHS、UL94V-0、Anti-UV (UV-function)
- 8: Operating cycles: 2000(Connector without breaking capacity)
- 9: Values for cable clamp:4.5-9.2mm
- 10: Termination and connection: Solder termination

REV.	ECN NO OR DESCRIPTION	REVISED	DATE
V1			
V2			
V3			

The recommended dimensions for the cable (Color not specified)

$4 \pm 1 = 10 \pm 2$

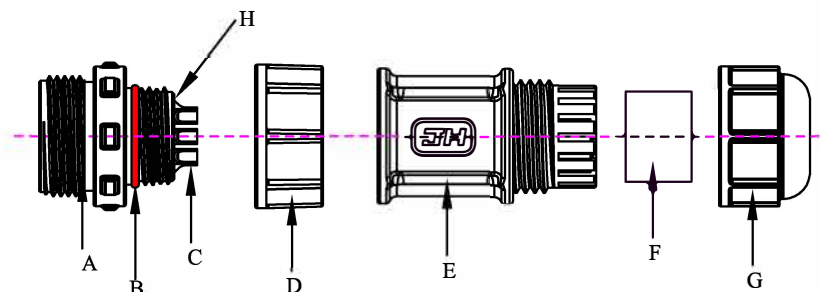
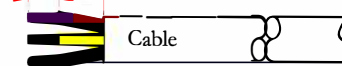

F can choose

Mark "0": Matching cable diameter 7.5-9.2mm

Mark "1": Matching cable diameter 6-7.5mm

Mark "2": Matching cable diameter 4.5-6mm

H	Potting	Epoxy		BLACK
G	Lock Nut	PA66+33%GF	1	BLACK
F	Seals Ring	Silica gel 45° (Optional aperture)	1	BLACK
E	Shell	PA66	1	BLACK
D	Lock Nut	PA66+33%GF	1	BLACK
C	Male needle	Ø1.0mm Copper plated gold 3μ"	3	Golden
		Ø1.5mm Copper plated gold 3μ"	2	Golden
B	O-Ring	Silica gel 45°	2	RED
A	Connector Body	PA66+33%GF	1	BLACK
			QTY	COLOR

RELEASE DATE	03.15/2017		
DECIMALS: X :±0.5 X.X :±0.3 X.XX :±0.2 XX.X :±1	UNIT	mm	
	VER	V0	
	SCALE	1:1	
	SIZE	A4	
			THIRD ANGLE PROJECTION

4

3

2

CONNECTOR®