

| VIEW | TOLERANCE | |
|----------|-----------|------|
| | 0-10 | ±1 |
| | 11-250 | ±5 |
| UNIT: mm | 251-500 | ±10 |
| | 501-1000 | ±20 |
| | 1001-3000 | ±50 |
| | 3001-5000 | ±100 |
| | 5001-> | ±150 |

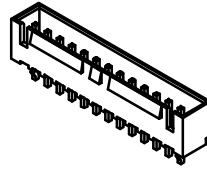
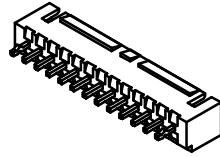

△ Order Code : 2317-XX-SL

Straight Angle
Number of contact : 2 to 16 pin

**TTAF
APPROVAL**

△ Material : Nylon 66 UL94V-0
PIN: Brass/Tin-plated

Voltage Rating : 250V AC,DC
Current Rating : 2A.
Withstanding Voltage : 1000V AC/minute
Insulation Resistance : 1000M Ω Min
Temperature Range : -25 °C ~ + 85 °C
Contact Resistance : 20m Ω Max.

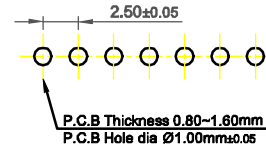

P.C.B. LAYOUT

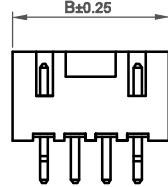
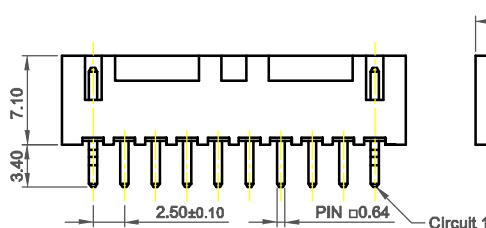

04-06Pin

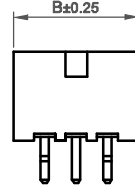

02-03Pin

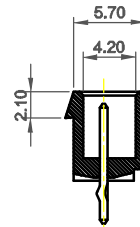

With Kink

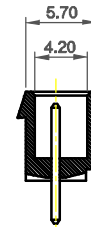

Without Kink

| Contact No. | Dimensions (mm) | |
|-------------|-----------------|-------|
| | A | B |
| 2 | 2.50 | 7.50 |
| 3 | 5.00 | 10.00 |
| 4 | 7.50 | 12.50 |
| 5 | 10.00 | 15.00 |
| 6 | 12.50 | 17.50 |
| 7 | 15.00 | 20.00 |
| 8 | 17.50 | 22.50 |
| 9 | 20.00 | 25.00 |
| 10 | 22.50 | 27.50 |
| 11 | 25.00 | 30.00 |
| 12 | 27.50 | 32.50 |
| 13 | 30.00 | 35.00 |
| 14 | 32.50 | 37.50 |
| 15 | 35.00 | 40.00 |
| 16 | 37.50 | 42.50 |

| Date | 03.11.2014 | Rev. | Revision Detail | Rev.Dt. | Rev.by | Part No | | |
|-------------|--------------|------|-----------------|---------|--------|-------------------|-------|----------|
| Designed by | Yeşim AKSOY | - | | | | 2317-XX-SL | | |
| Checked by | Fatih BOLACA | | | | | | | |
| | | | | | | Drawing Nr. | Scale | Sheet No |
| | | | | | | - | NONE | 1/1 |