

VIEW	TOLERANCE	UNIT
0-10	±1	mm
11-250	±5	
251-500	±10	
501-1000	±20	
1001-3000	±50	
3001-5000	±100	
5001- >	±150	

▲ Order Code : 2013-XX-H

Housing  
Number of contact : 2 to 15 pin

**TTAF  
APPROVAL**

■ Specifications :

- Voltage rating: 100V AC / DC
- Current rating: 2A AC / DC
- Withstanding voltage: 500V AC/minute
- Temperature range: -25°C~+85°C
- Insulation resistance: ≥500MΩ
- Contact resistance: ≤20mΩ
- After environmental testing: ≤40mΩ

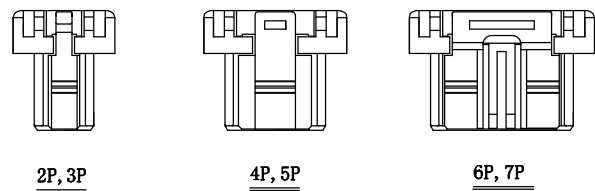
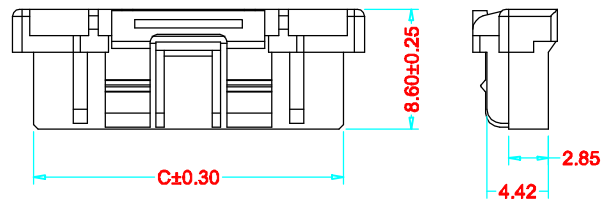
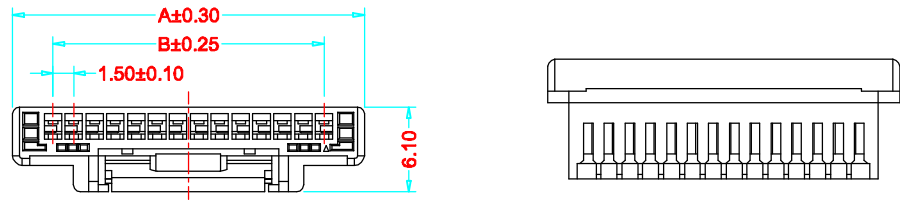

Poles	Dimensions (mm)		
	A	B	C
2	7.30	1.50	4.25
3	8.80	3.00	5.75
4	10.30	4.50	7.25
5	11.80	6.00	8.75
6	13.30	7.50	10.25
7	14.80	9.00	11.75
8	16.30	10.50	13.25
9	17.80	12.00	14.75
10	19.30	13.50	16.25
11	20.80	15.00	17.75
12	22.30	16.50	19.25
13	23.80	18.00	20.75
14	25.30	19.50	22.25
15	26.80	21.00	23.75

Date	03.11.2014	Rev.	-	Revision Detail		Rev.Dt.		Rev.by		Part No	<b>2013-XXH</b>		
Designed by	Yeşim AKSOY												
Checked by	Fatih BOLACA												
											Drawing Nr.	Scale	Sheet No
											-	NONE	1/1