

VIEW	TOLERANCE	
	0-10	±1
	11-250	±5
	251-500	±10
	501-1000	±20
	1001-3000	±50
UNIT: mm	3001-5000	±100
	5001->	±150

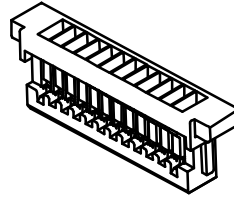
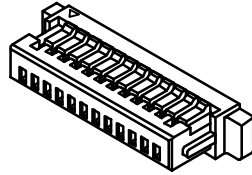

△ Order Code : 1600-XX-H

Housing

Number of contact : 2 to 20 pin

**TTAF  
APPROVAL**

△ Material : PBT + GF15 % UL94V-0

Voltage Rated : 50V AC,DC  
 Current Rated : 1A. AC,DC  
 Withstand Voltage : 500V AC/minute  
 Insulation Resistance : 500M Ω/Min  
 Temperature Range : -25 °C ~ + 85 °C

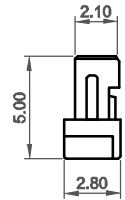
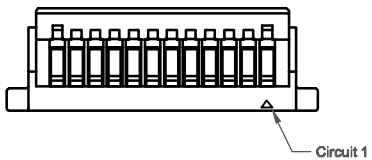
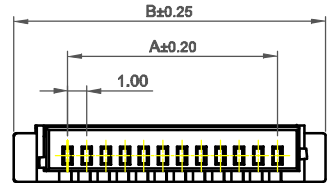

Contact No.	Dimensions (mm)	
	A	B
2	1.00	5.00
3	2.00	6.00
4	3.00	7.00
5	4.00	8.00
6	5.00	9.00
7	6.00	10.00
8	7.00	11.00
9	8.00	12.00
10	9.00	13.00
11	10.00	14.00
12	11.00	15.00
13	12.00	16.00
14	13.00	17.00
15	14.00	18.00
16	15.00	19.00
17	16.00	20.00
18	17.00	21.00
19	18.00	22.00
20	19.00	23.00

Date	03.11.2014	Rev.	-	Revision Detail		Rev.Dt.		Rev.by		Part No	<b>1600-XX-H</b>	
Designed by	Yeşim AKSOY	Checked by	Fatih BOLACA							Drawing Nr.		-
										Scale		NONE
										Sheet No	1/1	

