

VIEW	TOLERANCE	
	0-10	±1
	11-250	±5
UNIT: mm	251-500	±10
	501-1000	±20
	1001-3000	±50
	3001-5000	±100
	5001->	±150

Δ Order Code : 1200-XX-H

Housing  
Number of contact : 2 to 30 pin

**TTAF  
APPROVAL**

Δ Material : P.B.T UL 94V-0

Voltage Rating : 100V AC,DC  
Current Rating : 1A AC,DC  
Withstanding Voltage : 500V/minute  
Insulation Resistance : 100M Ω Min  
Temperature Range : -25°C ~ + 85°C

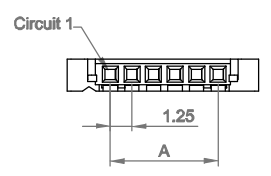
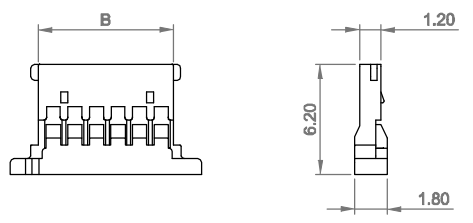
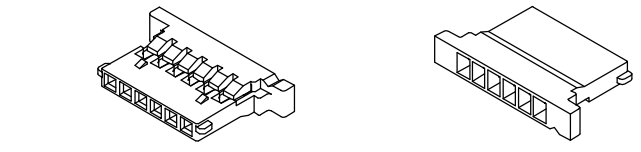

Contact No.	Dimensions(mm)	
	A	B
2	1.25	2.70
3	2.50	3.95
4	3.75	5.20
5	5.00	6.45
6	6.25	7.70
7	7.50	8.95
9	10.00	11.45
14	16.25	17.70
15	17.50	18.95
20	23.75	25.20
30	36.25	37.70

Date	10.04.2014	Rev.	-	Revision Detail		Rev.Dt.		Rev.by		Part No	<b>1200-XX-H</b>	
Designed by	Yeşim AKSOY									Drawing Nr.		-
Checked by	Fatih BOLACA									Scale		NONE
										Sheet No	1/1	